

FOLD UP SHELVING KIT ASSEMBLY GUIDE

CAUTION

This equipment is designed to be professionally installed by an approved up-fitter. Always wear ear and eye protection and exercise caution when installing Westcan products.

Preparation

1. Ensure all parts are present and accounted for before installation. Plan the location of your unit ahead of time to make sure your installation location does not impede any other components you are installing or damage the safety and functionality of your vehicle.
2. Read all the assembly instructions for any accessories that need to be integrated into your unit. Some accessories require special spacing to be installed correctly. Please read the entire assembly guide provided before proceeding with the installation.
3. Exercise extreme diligence when drilling holes. Please visually inspect all locations prior to drilling. Use thread lock on all bolts.

Fold Up Shelf And Top Strip Assembly

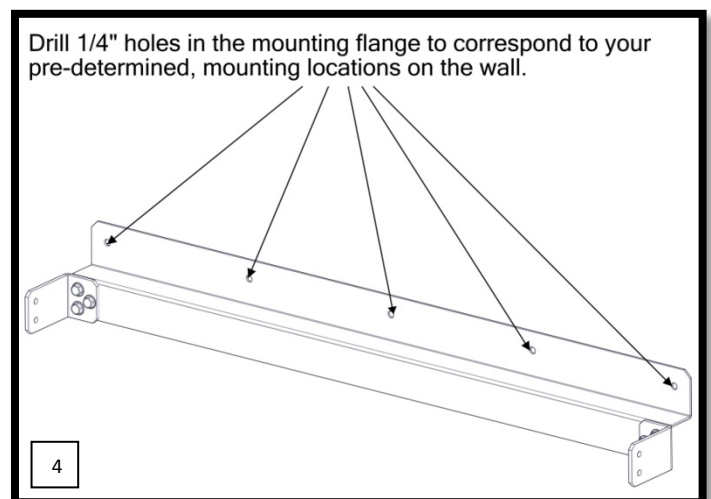
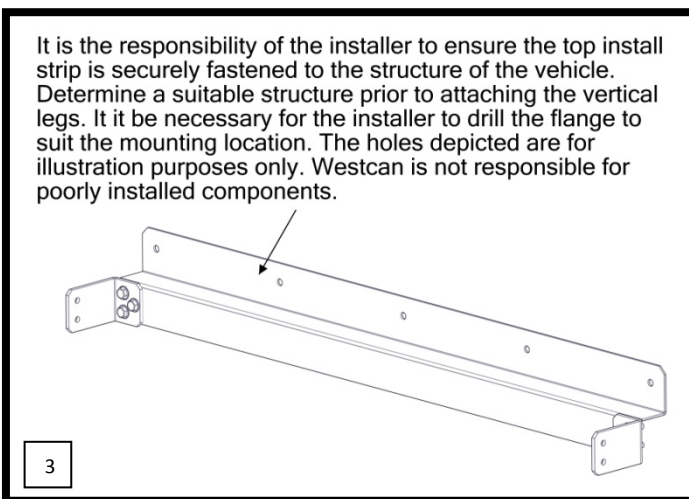
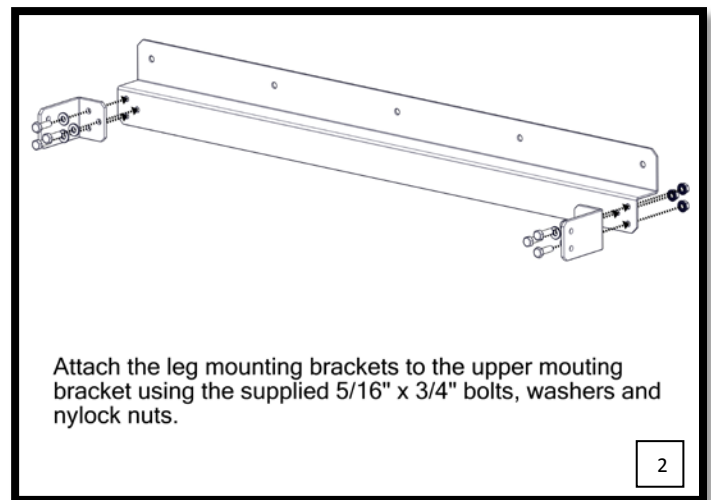
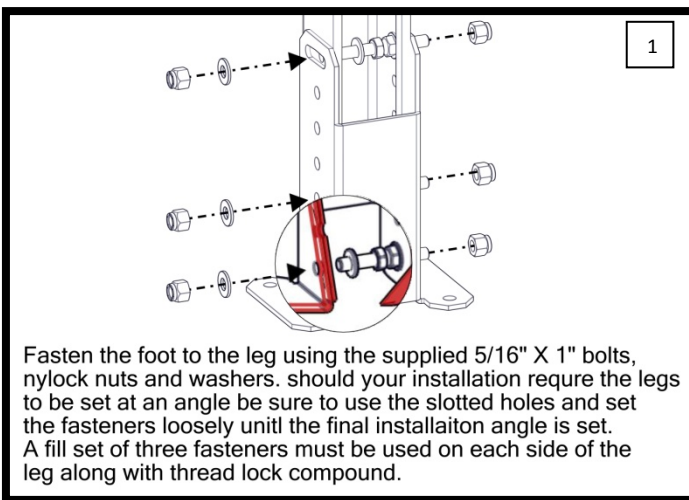

Attach the upper mounting bracket to the legs. The bracket can be lowered if it suits the install. Fasten using 5/16" X 3/4 bolts, nylock nuts and washers.

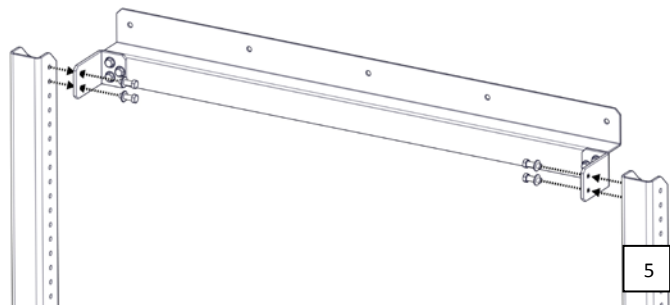

5

Using the 1/4" holes as a guide, mark the drill locations on the wall for the insert nuts.

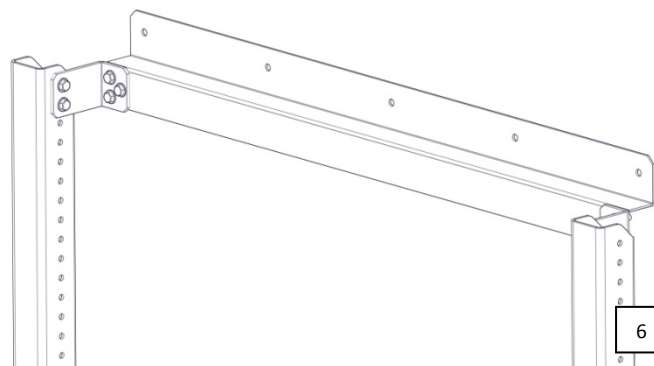

6

7

Mark mounting locations

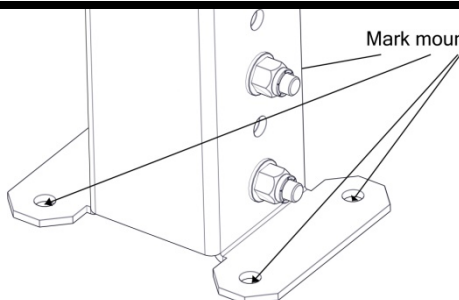

Once the top installation strip location is determined, mark the mounting locations using the foot as a guide. Repeat for the opposite leg. Ensure the legs are parallel prior to removal for smooth folding action.

Remove the assembled frame from the vehicle for shelf installation.

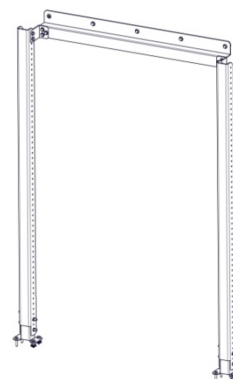

8

Fasten the end panels to the shelving extrusions using the supplied #14 x 1" hex screws.

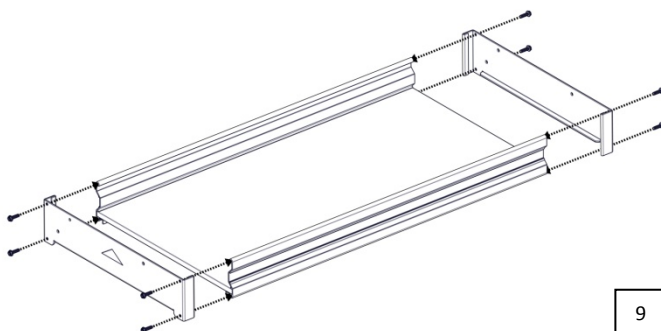

9

Fasten the 10mm ball stud to the end panels using the supplied 5/16" nylock nut and washer. Repeat for the opposite side

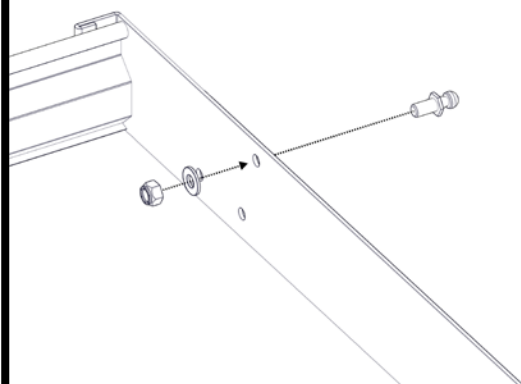

10

Using a 3/8" bolt, 3/8" nylon and metal washer, fasten the drop cable to the end panel using a 3/8" nylock nut. The cable head must be installed as illustrated and thread locking compound used. Be sure not to over tighten the nut as the cable must pivot freely. Repeat for the opposite end panel.

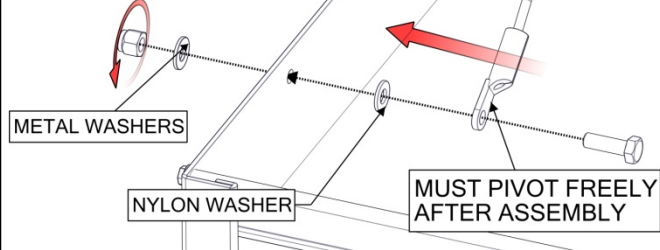

Press the rod end of the gas shock onto the ball stud on the end panel. Note that the rod end must face down for correct operation. Repeat for the opposite end panel.

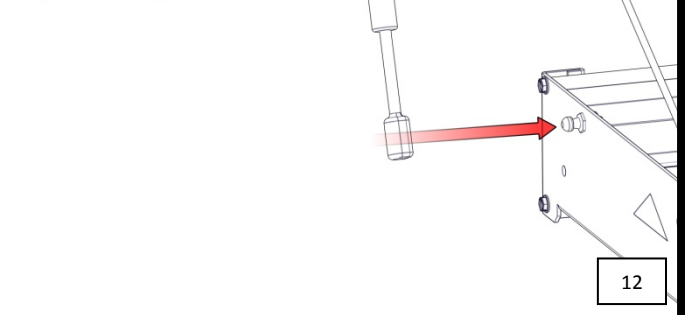

Fasten the rubber bumper to the bump stop bracket using the 10/24 X 3/4" machine screw and flange nut. It is recommended that a good quality thread is used prior to fastening the nut. Fasten the pull stud to the bracket using a 5/16" nylock nut and washer. Repeat for the opposite bracket.

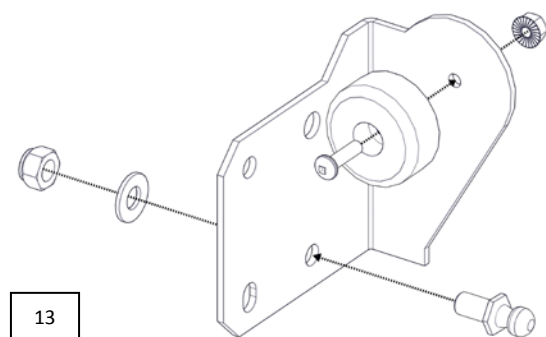

Using a 3/8" bolt and 3/8" nylon and flat washer, fasten the drop cable to the bracket using a 3/8" nylock nut. Apply thread lock compound prior to fastening. Be sure not to over tighten the nut as the cable must pivot freely. Repeat for the opposite bracket.

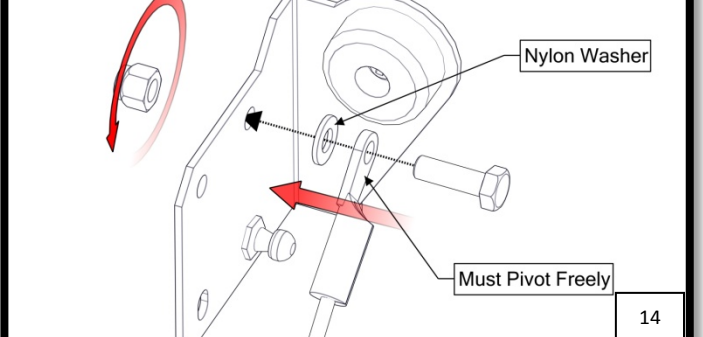

Attach the shelving pivot boss to the fold up shelf end panel using the supplied 5/16" x 3/4" bolt, Nylock nut and flat washer. Be sure to use a thread locking compound on the bolt.

Pivot holes in boss and end panel must be lined up prior to tightening

Pivot Hole.

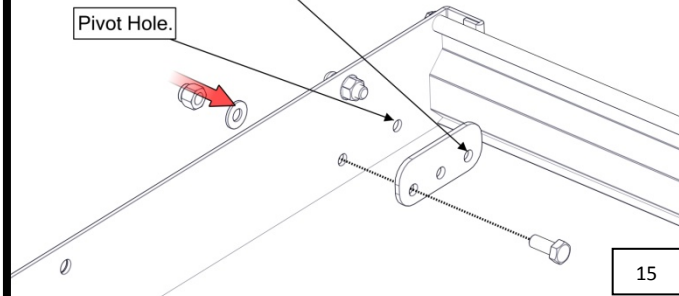

Determine your desired shelving position and fasten the shelf assembly to the support leg through the shelf leg pivot boss using the supplied 5/16" X 2" pivot bolt, 5/16" x 3/4" bolts, Nylock nut and Washer. Be sure to use a thread locking compound on all the fasteners installed. Do not to over tighten the pivot bolt, the shelf should pivot freely. Once the opposite support leg is in place repeat for that side.

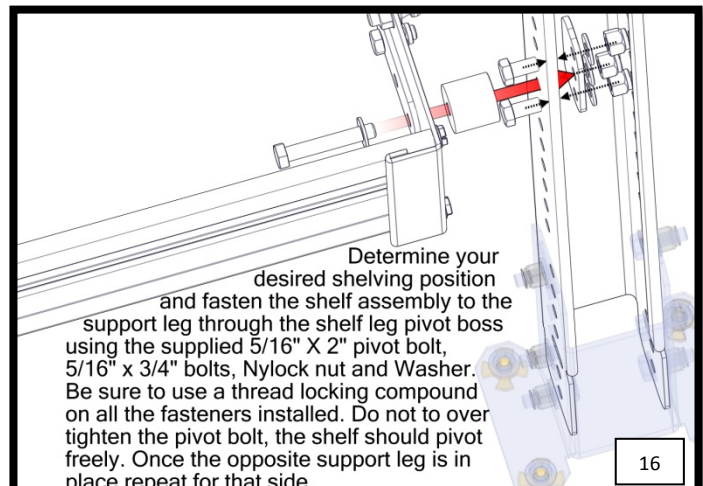

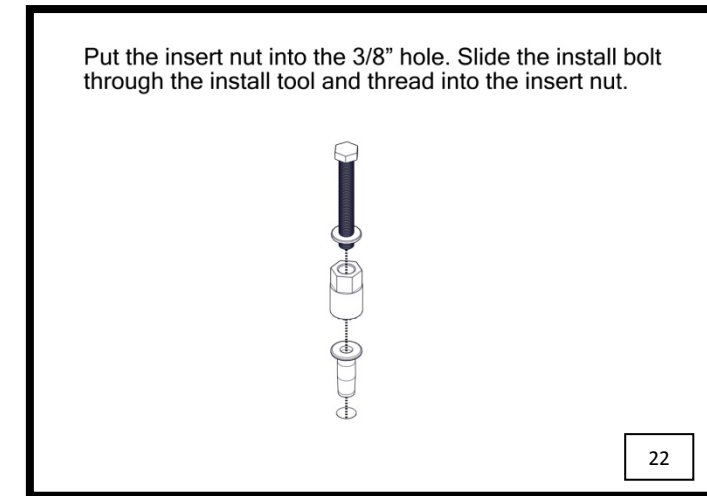
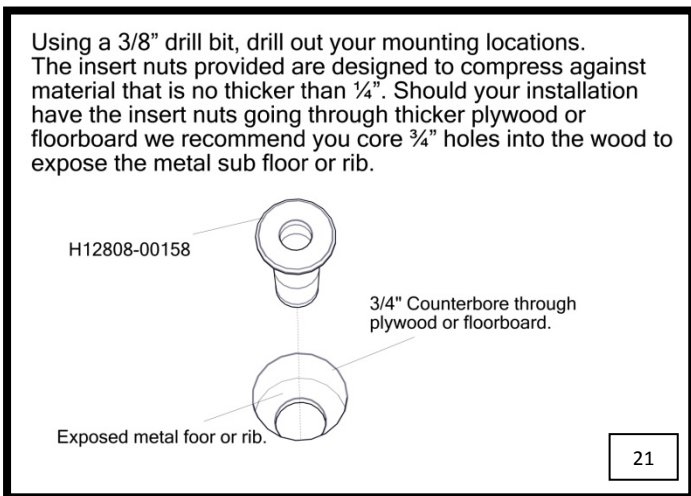
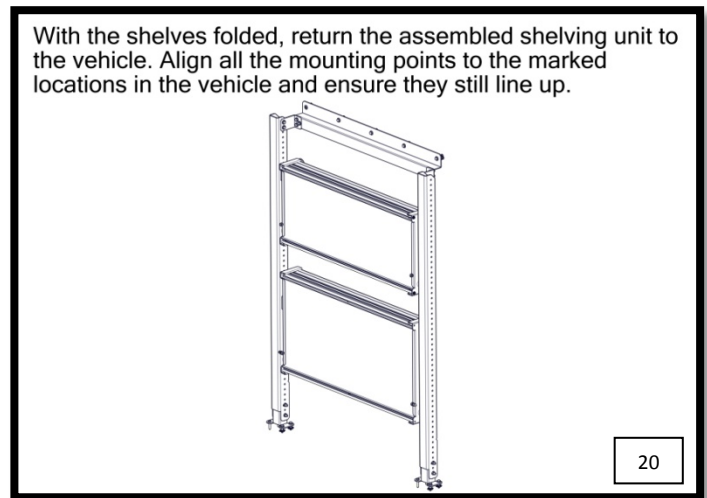
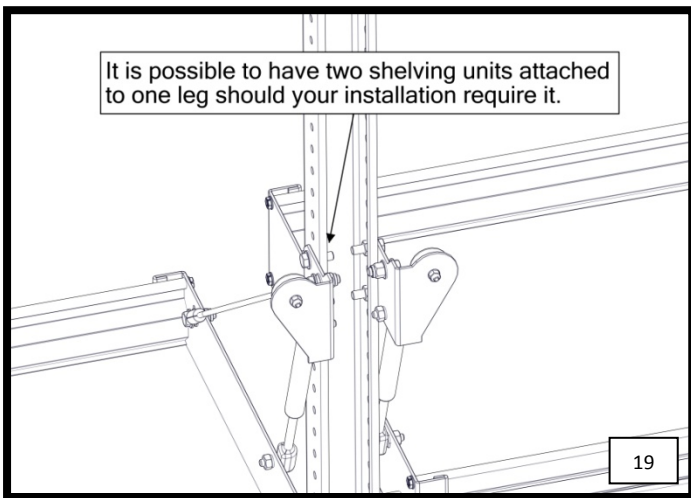
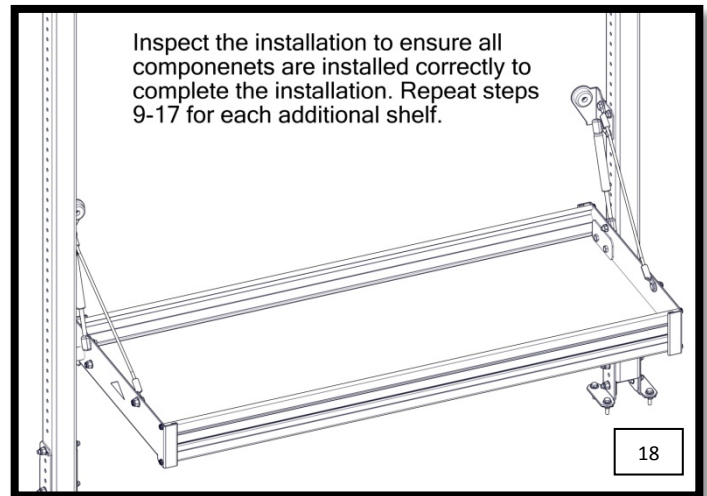
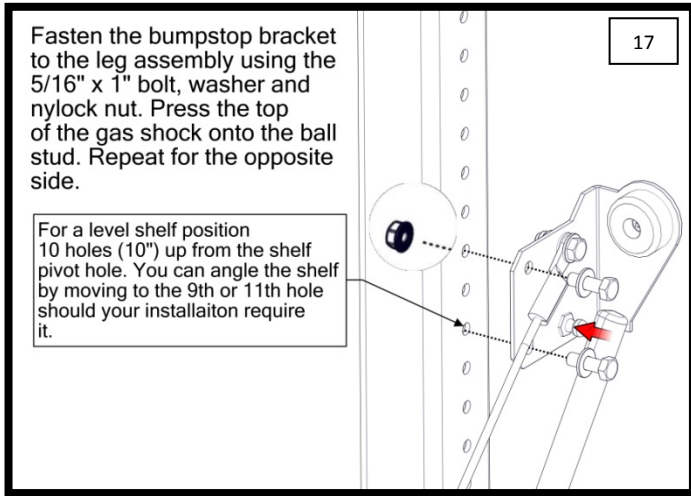

While holding the install tool stationary torque the insert nut down. Torque to 15 ft-lb if you are installing in 1/4" plywood or 25 ft-lb if inserted in metal or plywood that has a metal backing. Try to compress into metal wherever possible.

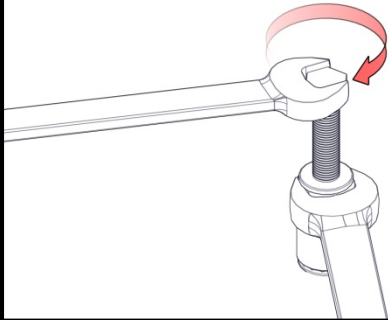

23

Fasten to the wall using the supplied 1/4" X 1-1/2" bolts, lock washers and washers. Use a good quality threadlock on the bolt threads.

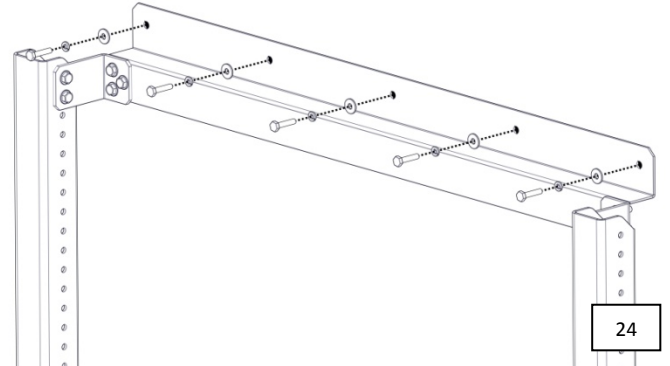

24

Fasten to the floor using the supplied 1/4" X 1-12" bolts, lock washers and washers. Use a good quality threadlock on the bolt threads.

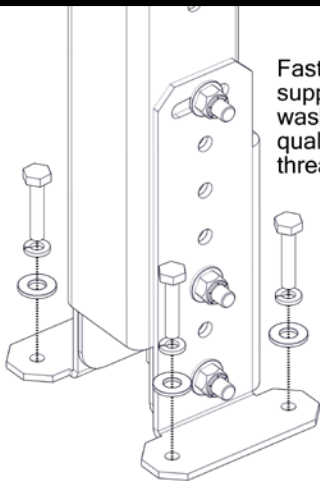

25

Tighten all fasteners and inspect the installation to ensure all components are installed correctly.

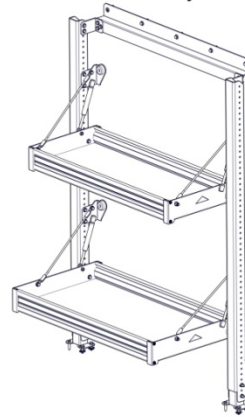

26